

Complete information and send with payment to  
address below to register for symposium.

**\$25.00 Registration fee**  
(includes lunch)  
**\$10.00 late fee after**  
**September 21.**

**PLEASE PRINT**

**NAME:** \_\_\_\_\_

**ADDRESS:** \_\_\_\_\_

\_\_\_\_\_

\_\_\_\_\_

**Phone:** \_\_\_\_\_

**Email:** \_\_\_\_\_

**Any questions, please contact:**

**Jennifer Akers**  
**260-356-6143**

**email: [jenniferakers@sbcglobal.net](mailto:jenniferakers@sbcglobal.net)**  
**or the Extension Office**

**260-358-4826**

**email: [huntingtonces@purdue.edu](mailto:huntingtonces@purdue.edu)**

**Make checks payable to:**  
**Huntington County Master Gardeners**

**Mail to:**  
**Purdue Extension Huntington County**  
**Courthouse Annex Suite 202**  
**354 N Jefferson St**  
**Huntington IN 46750**

Huntington County Master Gardeners  
Purdue Extension Huntington County  
Courthouse Annex Suite 202  
354 N Jefferson St  
Huntington IN 46750



# Huntington County Master Gardener Symposium

**Saturday**  
**October 6, 2007**

9:00 a.m.-3:30 p.m

Norwood Golf Club Lodge

5961 W Maple Grove Road  
Huntington IN

**Public Invited to Attend**



Please join us for the  
**Master Gardener Symposium on  
 October 6, 2007.**

The symposium is to expand your  
 knowledge and to meet others in-  
 terested in gardening.



**OPEN TO PUBLIC**

*Anyone may attend.  
 You DO NOT have to be  
 a Master Gardener.*

There will be vendors  
 for shopping and  
 door prizes for fun.



# SYMPOSIUM SCHEDULE

8:00 Registration (Refreshments Served)

9:00 Tree & Shrub Identification  
 for all Seasons  
**Sally Weeks**

10:15 Break

10:30 Gardening Naturally  
**Hillary Cox**

11:45 Lunch

1:00 Gardening for Continuous  
 Interest all 4 Seasons  
**Mary Welch-Keesey**

2:15 Foreign Invaders  
**Vince Burkle**  
 (Trip to see ash trees with Emerald Ash Borer)

3:30 Adjourn

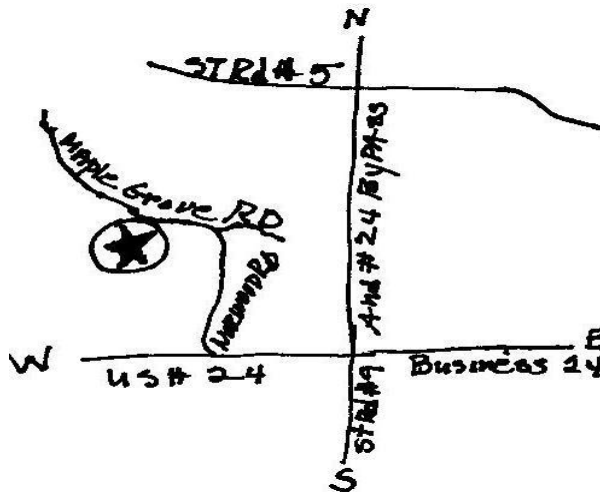

## BIOS

### Hillary V. Lee Cox

British born Ms. Cox moved to the US in 1984. A Master Gardener, Hillary has taught gardening classes at IU-PUI, Indianapolis, is a charter member of Indiana Native Plant and Wildflower Society (INPAWS) and has been involved in a number of garden projects in the Indianapolis area as well as internationally.

### Sally Weeks

Ms. Weeks utilizes her degrees in Wildlife Management and Forest Ecology as a teacher of Dendrology (trees) at Purdue for 20 years. She has published Trees of Indiana (available in book and CD form) and is currently working on a book of Native Shrubs and Woody Vines of Indiana.

### Mary Welch-Keesey

Dr Keesey is a Consumer Horticulture Specialist at Purdue. She is responsible for the Dick Crum Resource Center at White River Gardens in Indianapolis and is known for her knowledge and expertise on native plants, herbaceous ornamentals and plant propagation. She has a course on Plant Propagation available on CD-ROM.

### Vince Burkle

Mr. Burkle has a degree from Purdue in Entomology. He has 10 years experience in nursery, landscape and lawn care industries. Currently he is Nursery Inspector and Compliance Officer with the Indiana Department of Natural Resources Division of Entomology and Plant Pathology.

